

规格承认书

SPECIFICATION FOR APPROVAL

CUSTOMER 客户: _____

CUSTOMER P/N 客户料号: _____

PRODUCT NAME 品名: 45W Travel Adapter 旅行适配器

MODEL NO. 产品型号: JY-308 Pro

ROHS 环保: YES 是 NO 否

Color 颜色: BLACK 黑 WHITE 白

Remark 备注: _____

MSLFORCE 苛尼特					CUSTOMER APPROVAL (客户确认)
EDIT (制订)	Electronic Confirm (电子确认)	Structure Confirm (结构确认)	Packing Confirm (包装确认)	CHECK (审核)	CHECK (审核)
刘通					

客户确认签字,盖章请回传一份给我司存档

mtkchina limited
深圳苛尼特科技有限公司

add:3/F, 98 Bldg, No.5 MaShanTou Industrial area, MaTian Street,GuangMing New district, ShenZhen
地址: 深圳市光明新区公明街道马山头第五工业区98栋3楼

TEL|电话: 0086-755-61182305 FAX|传真: 0086-755-61182306 Website: www.mslforces.com

1. 描述 (Description)

本规格书适应于JY-308 Pro型号的旅行充电器.

This specification apply to the 45W Travel Charger whose model no. is JY-308 Pro.

2. 电气规格 (Electrical Specification)

2.1 输入 (INPUT)

输入电压范围 (Input voltage range)	90Vac - 264Vac
额定输入电压范围 (Rated voltage range)	100Vac - 240Vac
适用频率范围 (Input frequency range)	47Hz-63Hz
额定频率 (Rated input frequency)	50Hz/60Hz
输入电流 (Input current)	1A max. at full load

2.2 输出 (OUTPUT)

2.2.1 额定输出 (Rated Output)

输出电压 Output Voltage(Vdc)	输出电压范围 Output Voltage Limit(Vdc)	纹波&噪声 Output Ripple & Noise(mV)	最大输出电流 Output Current(mA)
单口输出 (Single output) :			
USB-C: 5Vdc	4.75-5.25Vdc	≤200	3000 mA
USB-C: 9Vdc	8.55~9.45Vdc	≤200	3000 mA
USB-C: 12Vdc	11.40~12.60Vdc	≤200	3000 mA
USB-C: 15Vdc	14.25~15.75Vdc	≤200	3000 mA
USB-C: 20Vdc	19.00~21.00Vdc	≤200	2250 mA
USB-A: 5Vdc	4.60-5.25Vdc	≤200	2400 mA
双口输出 (Double output) :			
USB-C: 5Vdc	4.75-5.25Vdc	≤200	3000 mA
USB-C: 9Vdc	8.55~9.45Vdc	≤200	3000 mA
USB-C: 12Vdc	11.40~12.60Vdc	≤200	2500 mA
USB-C: 15Vdc	14.25~15.75Vdc	≤200	2000 mA
USB-C: 20Vdc	19.00~21.00Vdc	≤200	1500 mA
USB-A: 5Vdc	4.60-5.25Vdc	≤200	2400 mA

Notes: 在测试纹波时示波器带宽调至20MHz,示波器的测试端并联一粒10uF的电解电容和一粒0.1uF的瓷片电容. (Ripple Voltage is measured with oscilloscope with bandwidth 20MHz . A 10uF E-cap and 0.1uF ceramic-cap shall be connected to the connector in parallel.)

2.2.2 负载特性,调整率 (Combined Load/Line Regulation)

电压 Voltage	最小负载 Min. Load	额定负载 Rated. Load	线性调整 Line Regulation	负载调整 Load Regulation
单口输出 (Single output) :				
USB-C: 5Vdc	0mA	3000 mA	±3%	±5%
USB-C: 9Vdc	0mA	3000 mA	±3%	±5%
USB-C: 12Vdc	0mA	3000 mA	±3%	±5%
USB-C: 15Vdc	0mA	3000 mA	±3%	±5%
USB-C: 20Vdc	0mA	2250 mA	±3%	±5%
USB-A: 5Vdc	0mA	2400 mA	±3%	±5%
双口输出 (Double output) :				
USB-C: 5Vdc	0mA	3000 mA	±3%	±5%
USB-C: 9Vdc	0mA	3000 mA	±3%	±5%
USB-C: 12Vdc	0mA	2500 mA	±3%	±5%
USB-C: 15Vdc	0mA	2000 mA	±3%	±5%
USB-C: 20Vdc	0mA	1500 mA	±3%	±5%
USB-A: 5Vdc	0mA	2400 mA	±3%	±5%

2.2.3 启动延迟时间 (Turn on delay time)

当输入115Vac和输出最大负载时,大启动时间为2S.

2Second Max. at 115Vac input and output Max. load.

2.2.4 效率 (Efficiency)

2.2.4.1 当230Vac输入20V/2.25A时,输出在25%,50%,75%及100%负载情况下,平均效率需达到86.03%(开机30分钟后测试).

When 230Vac is input into 20V/2.25A, the average efficiency should reach 86.03% under 25% and 100% load (test 30 minutes later).

2.2.4.2 空载输入功率 \leq 0.3W. No-load input power \leq 0.3W.

3. 保护功能 (Protection)

3.1 短路电路保护 (Short circuit protection)

该电源供给器在短路解除时能正常工作恢复.

The power supply will be auto recovered after short circuit faults remove.

3.2 过流保护 (Over current Protection)

过流故障排除后,电源将自动恢复正常工作,保护电流不得超过3900mA.

The power supply will be auto recovered after over current faults remove, And the protection current cannot exceed than the 3900mA.

4. 可靠性要求 (Reliability Requirements)

4.1. 老化 (Burn-in)

产品至少要在90%额定负载条件下煲机4小时

The Travel Charger shall be burn-in for 4 Hours under normal input and 90% rated load.

5. 环境要求 (Environment Requirement)

5.1 工作温度 (Operating Temperature)

0°C-40°C, 满载,正常工作

0°C to 40°C, Full load, Normal operation.

5.2 工作湿度 (Relative Humidity)

空气温度为32 +/-1°C,相对湿度为90 +/-5%,测试24小时.

Air temperature is 32 +/- 1°C with 90 +/-5% relative humidity for 24Hrs testing.

5.3 跌箱试验 (Carton Drop)

一个角,三个棱,六个面(高度: 24英寸).

1 corner,3 edges, and 6 surfaces(Height:24inch).

6. 安全及EMI要求 (Safety and EMI Requirement)

6.1 安全:符合标准 (Safety:accord with)

Certificate		Country	Standards
■FCC		美国/USA	Class B
■CE-LVD		欧洲/Europe	EN60950
■CE-EMC		欧洲/Europe	EN55032,EN55035, EN61000
■RoHS		欧洲/Europe	IEC62321:2013

6.2 绝缘强度 (Dielectric Strength Testing)

绝缘强度满足下表的要求,100%在线产品执行此项测试,并每一项目至少保持3S时间,无任何故障.

Hi-pot test shall be met the following table requirements, an item listing this test as a 100% production test must be performed and be maintained at that level for a minimum of 3 seconds without failure.

项目(ITEM)	测试规格(SPECIFICATION)	结果(REMARK)
输入- 输出 Primary to Secondary	3000Vac/1mA/3s	无拉弧 No arcing

7. 测试设备清单 (Test Equipment List)

项目	设备名称	制造	型号
1	变频电源 (AC power source)	普斯	PC-61005

2	示波器 (Oscilloscope)	美瑞克	SDS 1102 CNL
3	电子负载仪 (Electronic load)	ITECH	IT8510
4	万用表 (Multimeter)	VICTOR	VC8900
5	功率计 (Dynamometer)	EVERFINE	PF9901
6	老化测试架 (Burn-in tester)	PengCe Technology	PC-BI96E
7	数显卡尺 (Digimatic caliper)	GuangLu	0-150mm
8	跌落测试台 (Drop test bed)	/	ASTM F963

8. 结构参数 (MECHANICAL REQUIREMENT)

8.1 外壳 (Enclosure)

外壳尺寸, The size: L: 78.2 x W: 54.7 x H: 52.6 mm.

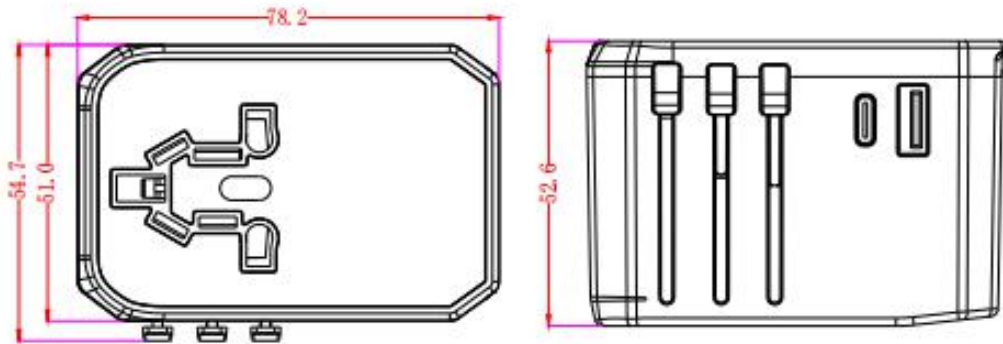

8.2 插脚 (Plugs)

插脚尺寸, Plugs size: L: x W: x H: mm. (Details as follows)

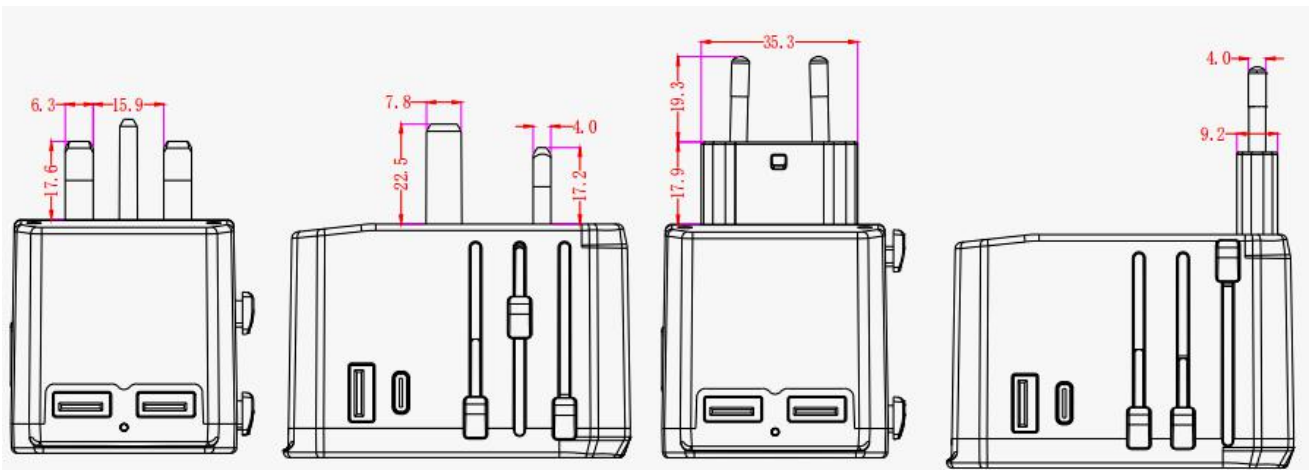

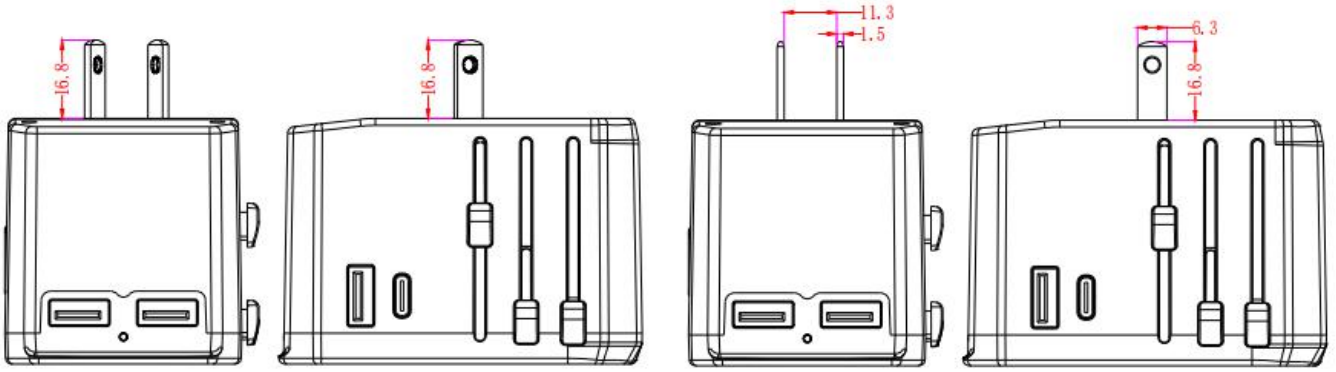

9. 重量 (Weight)

旅行充电器的重量大约为185g.

The weight of the Travel Adapter shall be about 185g.

10. 铭牌图 (Label Drawing)

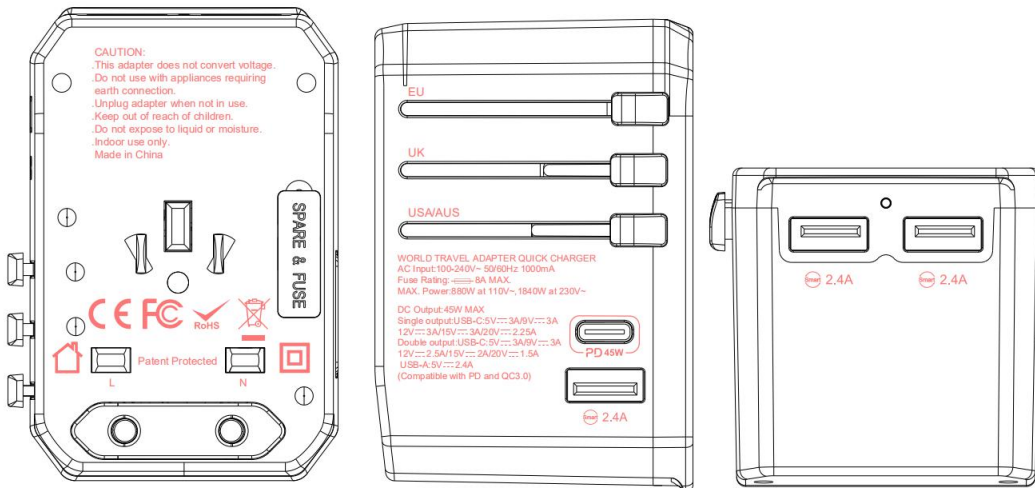

11. 包装图 (Package Drawing)

11.1 100PCS/箱,100PCS/CTN.

Note: 若客户未提出包装方式时,均使用本公司之包装方式.

Our own packing style will be adopted if no special packing required .

11.1.1 内包装/Inner package

PP袋/PP bag,白盒/White box

11.1.2 外包装/Outer package

纸箱/paper-box.

纸箱尺寸,CTN size: 340.5 × 310.5 × 330.0mm.

11.1.3 外包装箱标识/Outer carton notes include the information

数量,毛重,净重及外箱尺寸等信息..

Quantity,Gross weight,Net weight and Measure etc..

11.2 外箱图片,Outside carton picture

Main mark x 2



Side mark x 2

